



THERMAL BLANKET

PRODUCT SPECIFICATIONS



13526 Hwy 55
McCall, ID 83638
USA
208-634-0055

P.O. Box 1029
Coeur d'Alene, ID 83816
USA
208-683-1444

info@bigcabin.com
www.bigcabin.com

MARCH 2021

THERMAL BLANKET COMPONENTS

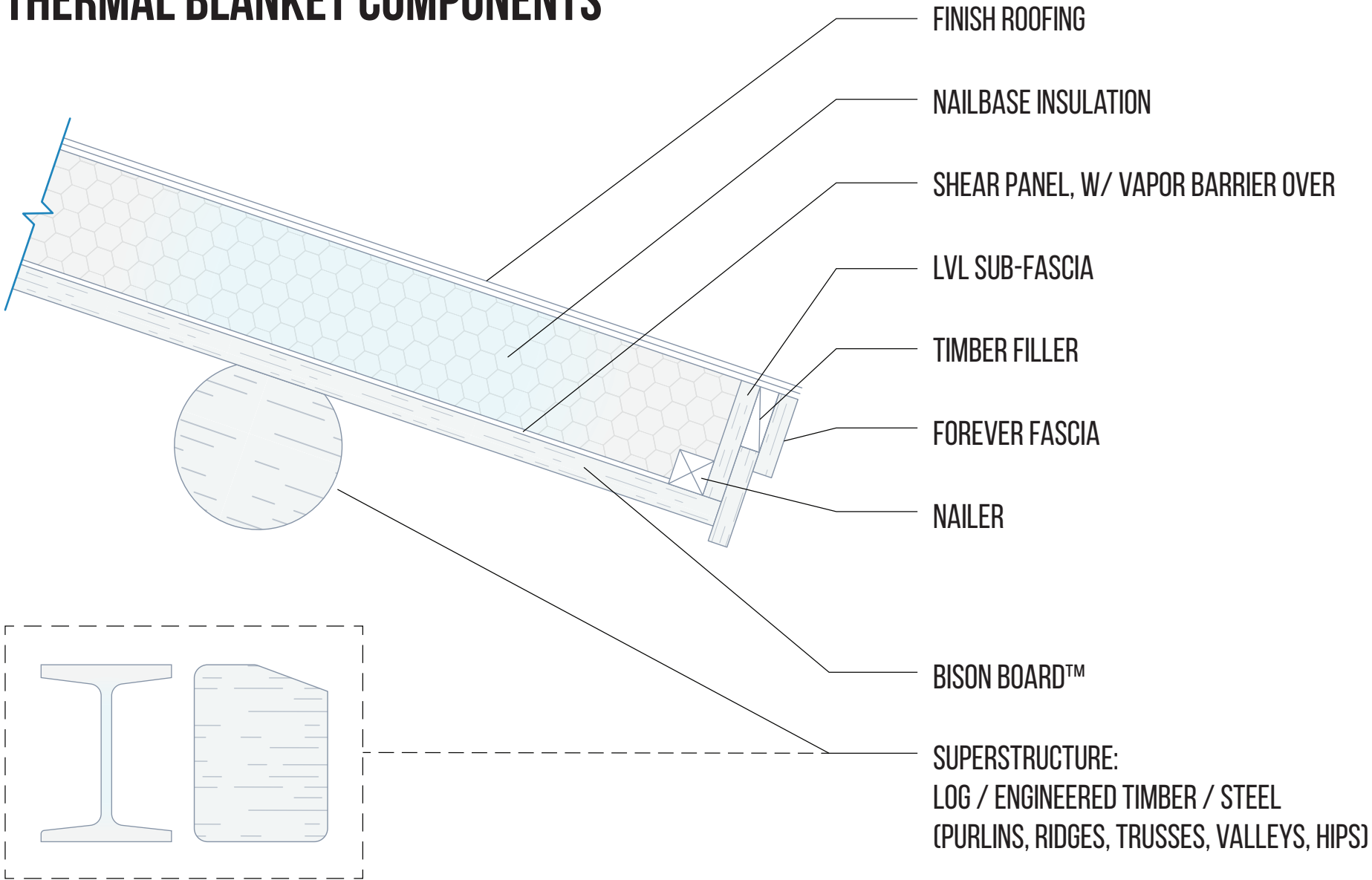

SUPERSTRUCTURE

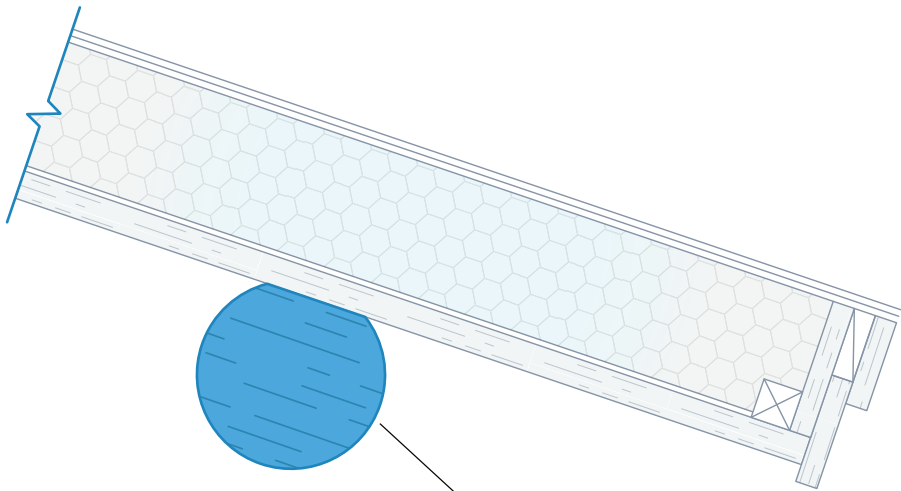

LOG SUPERSTRUCTURE:
(PURLINS, RIDGES, TRUSSES, VALLEYS, HIPS)



MATERIAL	Inland Douglas Fir / Western Larch		
DIMENSION*	12"-20"	Continuous Full Length. Max Length of 45'	
GRADE	No. 1	No. 2 & Better	Appearance Grade
COLOR	Raw Unstained	SchaferWood Antique	Custom Stain
TEXTURE	Hand Hewn	Brushed	Resawn

*Requests for custom sizes and materials warmly received

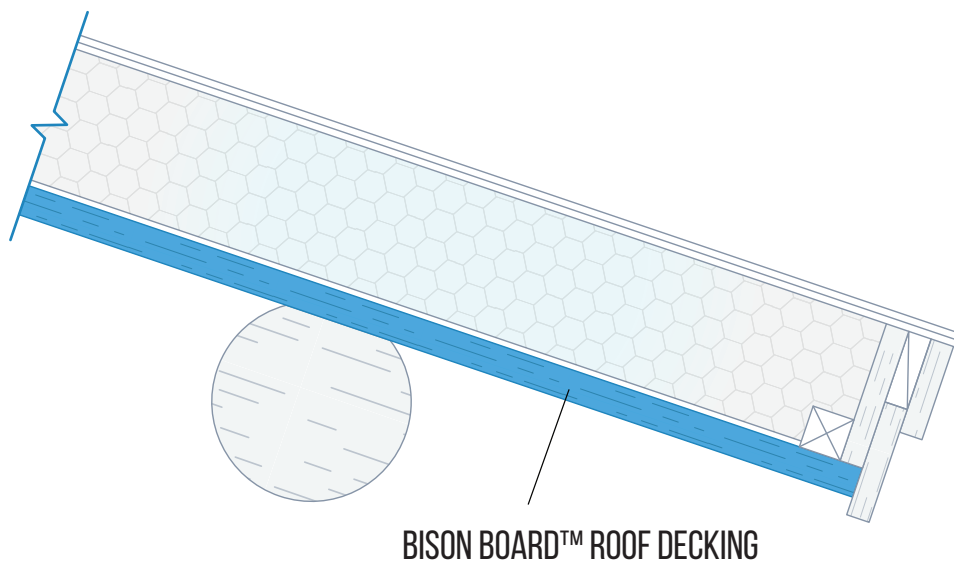

BISON BOARD™

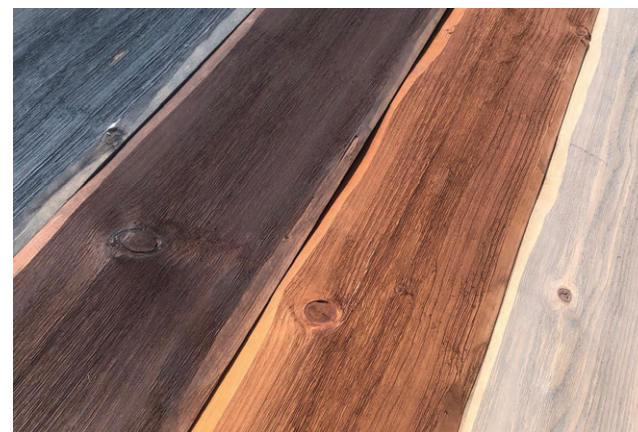

4 COLORS AVAILABLE



MATERIAL	Idaho White Pine		Inland Douglas Fir / Western Larch	Inland Western Red Cedar	
DIMENSION*	Nominal Size: 3" x 10"		Actual Size: 2 3/4" x 9 1/2"	Coverage: 9"	Length: 6' - 16'
GRADE	No. 2 Grade		Appearance Grade		
COLOR	Metal Bronze Altai Bronze	Timeless Charcoal Barnwood Gray	Raw Unstained	Custom Stain	
TEXTURE	Brushed		Smooth		

*Requests for custom sizes and materials warmly received

BISON BOARD™

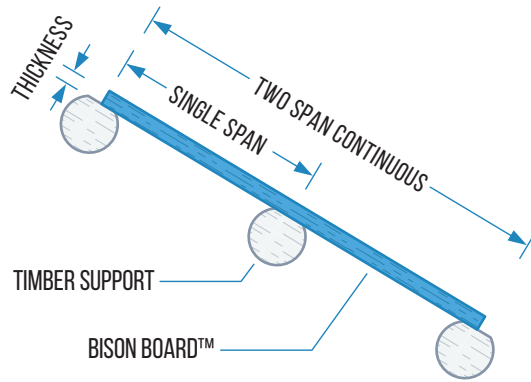

These Span Tables were developed using No. 2 & better grade lumber using WPA grade rules as an industry standard. Higher or lower grades are available, impacting the span values.

Single Span Bison Board™ is supported at two end points only.

Two Span Continuous Bison Board™ is supported at two end points and at one point inbetween.

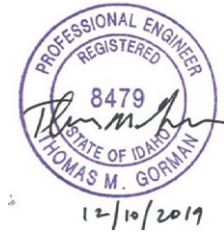

PREPARED BY T. GORMAN PH.D., P.E.

SPAN TABLES

Maximum spans (feet, inches) limited by deflection of L/240

		Snow Load (psf)																			
		25		30		35		40		45		50		60		70		80		90	
Timber Species	Thickness	Single Span	Two Span	Single Span	Two Span	Single Span	Two Span	Single Span	Two Span	Single Span	Two Span	Single Span	Two Span	Single Span	Two Span	Single Span	Two Span	Single Span	Two Span	Single Span	Two Span
IDAHO WHITE PINE, WESTERN RED CEDAR, & WESTERN WHITE WOOD	2 3/4"	12'3"	16'5"	11'5"	15'5"	10'11"	14'8"	10'5"	14'	10'	13'6"	9'8"	13'	9'1"	12'3"	8'8"	11'8"	8'3"	11'1"	7'11"	10'8"
	3 3/4"	16'8"	22'5"	15'8"	21'1"	14'11"	20'	14'3"	19'2"	13'9"	18'5"	13'3"	17'9"	12'5"	16'9"	11'10"	15'10"	11'4"	15'2"	10'11"	14'7"
	4 3/4"	21'2"	28'4"	19'11"	26'8"	18'11"	25'4"	18'1"	24'3"	17'5"	23'4"	16'9"	22'6"	15'9"	21'2"	15'	20'1"	14'4"	19'3"	13'9"	18'6"
DOUGLAS FIR & LARCH	2 3/4"	14'4"	19'2"	13'6"	18'1"	12'9"	17'2"	12'3"	16'5"	11'9"	15'9"	11'4"	15'3"	10'8"	14'4"	10'2"	13'7"	9'8"	13'	9'4"	12'6"
	3 3/4"	19'6"	26'2"	18'5"	24'8"	17'5"	23'5"	16'8"	22'5"	16'1"	21'6"	15'6"	20'9"	14'7"	19'7"	13'10"	18'7"	13'3"	17'9"	12'9"	17'1"
	4 3/4"	24'9"	33'2"	23'3"	31'3"	22'1"	29'8"	21'2"	28'5"	20'4"	27'3"	19'8"	26'4"	18'6"	24'9"	17'7"	23'6"	16'9"	22'6"	16'2"	21'8"

Snow Load (psf)																					
100		110		120		130		140		150		160		170		180		190		200	
Single Span	Two Span	Single Span	Two Span	Single Span	Two Span	Single Span	Two Span	Single Span	Two Span	Single Span	Two Span	Single Span	Two Span	Single Span	Two Span	Single Span	Two Span	Single Span	Two Span	Single Span	Two Span
7'8"	10'4"	7'5"	10'	7'2"	9'9"	7'1"	9'5"	6'10"	9'3"	6'8"	9'	6'6"	8'10"	6'5"	8'8"	6'3"	8'6"	6'2"	8'4"	6'1"	8'2"
10'6"	14'1"	10'2"	13'8"	9'11"	13'3"	9'7"	12'11"	9'5"	12'7"	9'2"	12'4"	9'	12'	8'9"	11'10"	8'7"	11'7"	8'6"	11'4"	8'4"	11'2"
13'4"	17'10"	12'11"	17'4"	12'6"	16'10"	12'2"	16'4"	11'11"	16'	11'7"	15'7"	11'5"	15'3"	11'2"	14'11"	10'11"	14'8"	10'9"	14'5"	10'7"	14'2"
9'	12'1"	8'9"	11'8"	8'6"	11'4"	8'3"	11'1"	8'	10'10"	7'10"	10'7"	7'8"	10'4"	7'6"	10'1"	7'5"	9'11"	7'3"	9'9"	7'2"	9'7"
12'3"	16'6"	11'11"	16'	11'7"	15'6"	11'3"	15'1"	11'	14'9"	10'9"	14'5"	10'6"	14'1"	10'3"	13'10"	10'1"	13'7"	9'11"	13'4"	9'9"	13'1"
15'7"	20'11"	15'1"	20'3"	14'8"	19'8"	14'3"	19'2"	13'11"	18'8"	13'7"	18'3"	13'4"	17'10"	13'1"	17'6"	12'10"	17'2"	12'7"	16'10"	12'4"	16'7"

BISON BOARD™

4 COLORS AVAILABLE



BARNWOOD GRAY

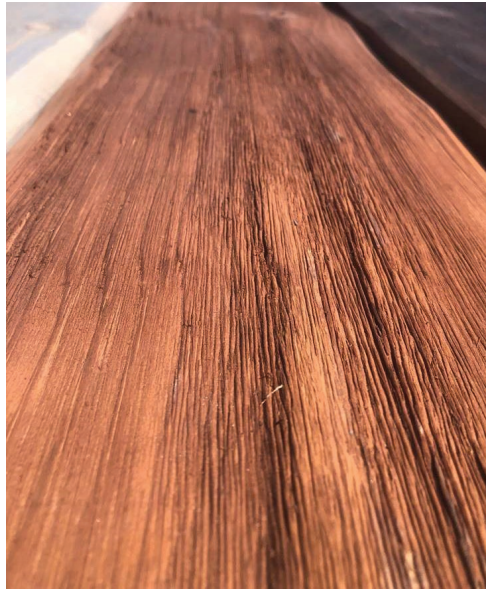

METAL BRONZE



TIMELESS CHARCOAL

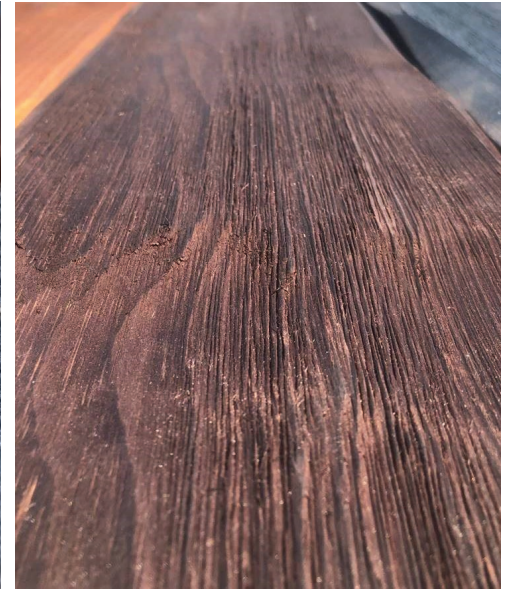

ALTAI BRONZE

CUSTOMIZATION	Custom color formulas can be produced
----------------------	---------------------------------------